

DATE	BY
12/2005	W. J. SCHINDLER
12/2006	W. J. SCHINDLER
12/2007	W. J. SCHINDLER
12/2008	W. J. SCHINDLER
12/2009	W. J. SCHINDLER
12/2010	W. J. SCHINDLER
12/2011	W. J. SCHINDLER
12/2012	W. J. SCHINDLER

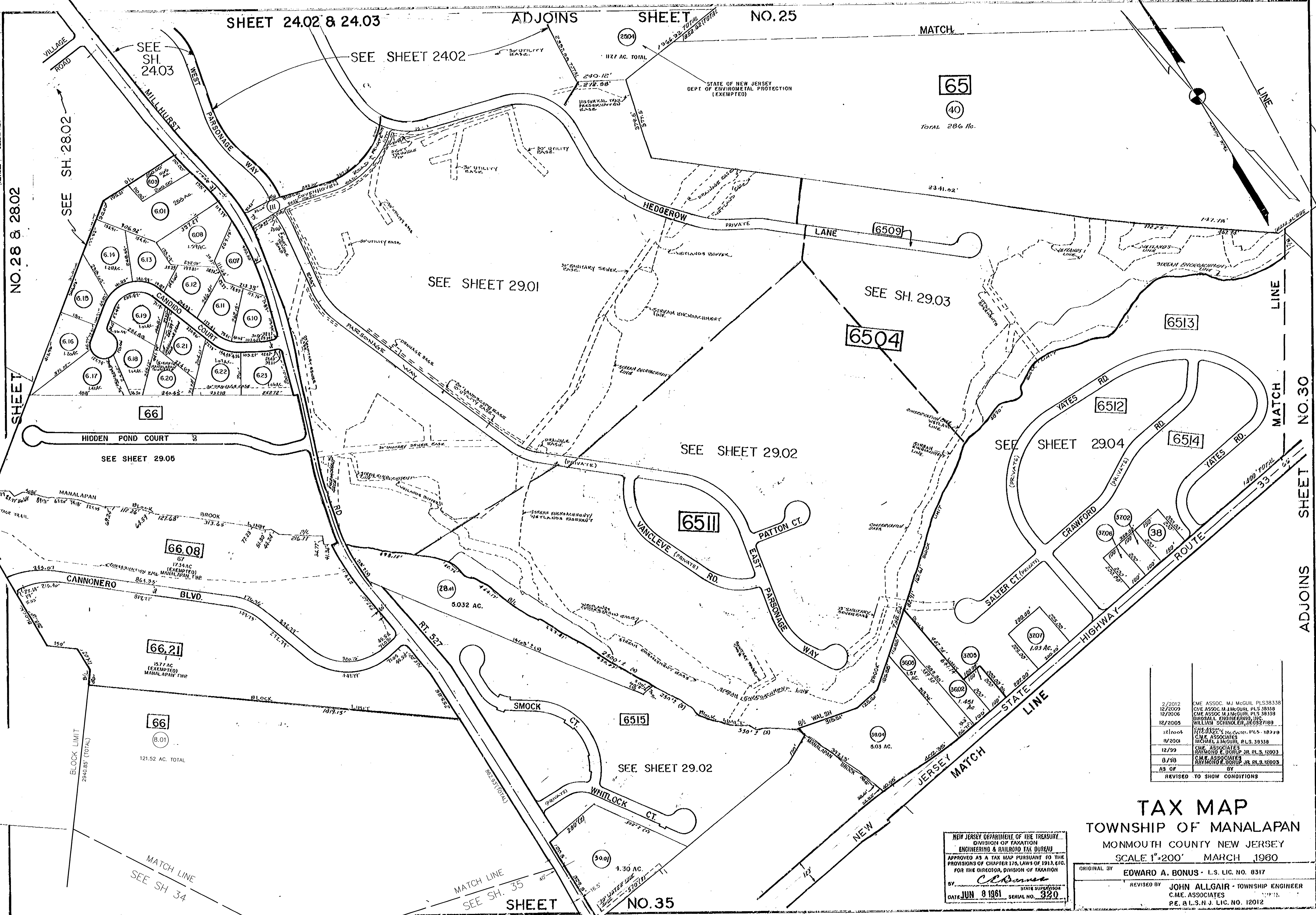

2/2012	CME ASSOC. M.J. MCGUIR, P.L.S. 38338
12/2009	CME ASSOC. M.J. MCGUIR, P.L.S. 38338
12/2006	CME ASSOC. M.J. MCGUIR, P.L.S. 38338
12/2005	BROOKHILL ENGINEERING, INC. WILLIAM SCHINDLER, JR. P.L.S. 12803
12/2004	CME ASSOC. M.J. MCGUIR, P.L.S. 38338
12/2001	CME ASSOC. M.J. MCGUIR, P.L.S. 38338
12/99	CME ASSOC. M.J. MCGUIR, P.L.S. 38338
8/98	CME ASSOC. M.J. MCGUIR, P.L.S. 38338
A3 OF	BY
REVISED TO SHOW CONDITIONS	

TAX MAP
TOWNSHIP OF MANALAPAN
 MONMOUTH COUNTY NEW JERSEY
 SCALE 1"=200' MARCH 1980

NEW JERSEY DEPARTMENT OF THE TREASURY
 DIVISION OF TAXATION
 ENGINEERING & RAILROAD TAX BUREAU
 APPROVED AS A TAX MAP PURSUANT TO THE
 PROVISIONS OF CHAPTER 175, LAWS OF 1913, ETC.
 FOR THE DIRECTOR, DIVISION OF TAXATION
 BY *Cl. Brown*
 DATE JUN 8 1981 SERIAL NO. 320

ORIGINAL BY EDWARD A. BONUS - L.S. LIC. NO. 8317
 REVISED BY JOHN ALLGAIER - TOWNSHIP ENGINEER
 C.M.E. ASSOCIATES
 P.E. & L.S.N.J. LIC. NO. 12012